

Weekly cleaning

Autobar Enjoy



Refer to the safety instructions and to the chapter „Cleaning“ inside the user manual!

caution!
User at risk!



Never reach into the machine or under the beverage outlets during the automatic cleaning!

caution!
Machine at risk!



Execute the weekly cleaning process in minimum once per week! The weekly process is complementary to the daily cleaning and does not replace it!

Mixing bowl (Powdersystem)



This cleaning is only necessary by machines with the option "Powder-system".

- ▶▶ Switch off the machine with the button.
- ▶▶ Remove mains plug.



- ▶▶ Remove the milk storage cover.
- ▶▶ Remove the topping hose from the combi-outlet.

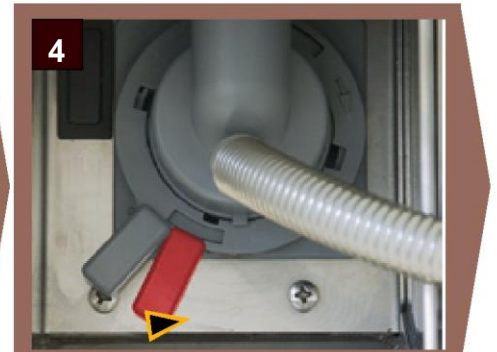

- ▶▶ Turn the bayonet fixing underneath the mixer jug counter-clockwise.
 - ☒; Mixer jug is released from the ar-rester lock.
 - ☒; The propeller of the mixer is now visible and can be cleaned with a cloth.



- ▶▶ Dismantle two-piece mixer jug.
- ▶▶ Clean both parts of mixer jug and mixer tubing under warm running water.
- ▶▶ Allow all parts to dry completely.



- ▶▶ Re-assemble all components. On re-assembly all openings must face in the same direction.
- ▶▶ Replace mixer jug.
- ▶▶ Turn the bayonet fixing underneath mixer jug back in clockwise direction.
- ▶▶ Push mixer tube on mixer jug pipe and combi spout pipe intakes.
- ▶▶ Replace milk compartment lid.