

# Weekly cleaning

## Schaerer Coffee Vito



Refer to the safety instructions and to the chapter „Cleaning“ inside the user manual!

**CAUTION!**  
User at risk!



Never reach into the machine or under the beverage outlets during the automatic cleaning!

**CAUTION!**  
Machine at risk!



Execute the weekly cleaning process in minimum once per week! The weekly process is complementary to the daily cleaning and does not replace it!

### Mixing bowl (Powdersystem)



*This cleaning is only necessary by machines with the option "Powder-system".*

- ▶ Switch off the machine with the button.
- ▶ Remove mains plug.



- ▶ Remove the milk storage cover.
- ▶ Remove the topping hose from the combi-outlet.

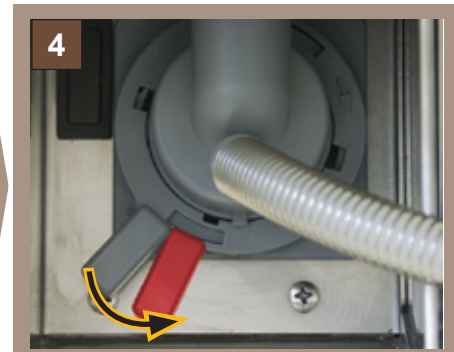

- ▶ Turn the bayonet fixing underneath the mixer jug counter-clockwise.
  - Mixer jug is released from the ar-rester lock.
  - The propeller of the mixer is now visible and can be cleaned with a cloth.



- ▶ Dismantle two-piece mixer jug.
- ▶ Clean both parts of mixer jug and mixer tubing under warm running water.
- ▶ Allow all parts to dry completely.



- ▶ Re-assemble all components. On re-assembly all openings must face in the same direction.
- ▶ Replace mixer jug.
- ▶ Turn the bayonet fixing underneath mixer jug back in clockwise direction.
- ▶ Push mixer tube on mixer jug pipe and combi spout pipe intakes.
- ▶ Replace milk compartment lid.

## Brewing unit

**CAUTION!**  
Risk of squeezing!



When operating movable parts, there is a risk of injury due to crushing!

**CAUTION!**  
Machine at risk!



Never clean the brewing unit in a dishwasher and never use any cleaner additives.

1

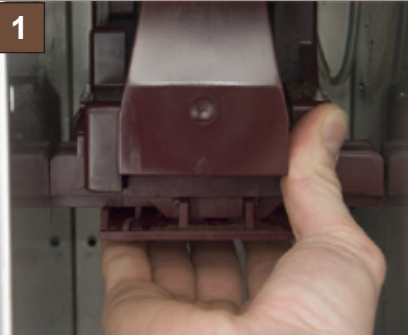

- ▶ Switch off the machine with the  button.
  - ▶ Remove mains plug.
  - ▶ Push combi spout fully upwards.
  - ▶ Remove grounds container towards the front of the machine.
  - ▶ With one hand reach into the chute under the brewing unit and release the retaining catch.
- Brewunit slips downwards!

2



- ▶ Slowly guide the brewing unit downwards, tilt and pull forward.

3



- ▶ Turn the thread on the brewing unit head counter-clockwise until the wiper is in the forward position.

4



- ▶ Push the spring outwards over the edge and unlock.
- ▶ Swing the insertion chute upwards.
- ▶ Remove residual coffee grounds using a paint-brush or scrubber.
- ▶ Rinse brewing unit under running water.

5



- ▶ Clean the brewer sieve under running water or using a cloth.
- ▶ Allow to dry completely before replacing in the coffee machine.
- ▶ Remove coffee ground residues in the chute.
- ▶ Reinstall the dry brewing unit.

## Water tank / Milkbox

### Water Tank Cleaning

- ▶ Wipe weekly or as required with a damp cleaning cloth.

### Milkbox Cleaning

- ▶ Wipe weekly or as required with a damp cleaning cloth.